



BY ERIC KUSTER



Maretti Lighting
Bolderweg 7

1332 AX Almere
the Netherlands

T +31 (0) 36 532 66 12

E info@maretti.com
W www.maretti.com

Sophisticated and sexy - typical of both his designs and his personality; Eric Kuster is one of the most popular international interior designers. High-end design typifies its Metropolitan Luxury style, a subtle blend of luxury and comfort.

The collaboration with Maretti Lighting can be called a perfect synergy and is reflected in a line of luxury lighting fixtures.

© Copyright Maretti Projectverlichting.

Our IM was made with the greatest of care. Nevertheless, the colours displayed in the IM may differ slightly from the real colours because of the printing process. Colour, size and range are subject to change. Nothing from this IM may be copied, reproduced and/or published by print, photocopy or in any other way without Maretti Lighting's written permission. All product and design copyrights belong to Maretti Lighting.

GUARANTEE TERMS AND CONDITIONS

The other party should inspect the delivered items immediately upon receipt with regard to its soundness. Entitlements to repair or replacement only exist if the other party

- In the case of visible defects, informs MPV of them immediately.

- In the case of defects that are not visible, informs MPV in writing of the defects, within 2 working days after the day the defects were found, or in all reason could have been found and furthermore demonstrates that the MPV instructions for use, maintenance and operation were followed, whilst the defects are not the consequence of normal wear and tear, misuse, negligence, accident, exceeding the limits prescribed by the MPV or by the legal safety regulations, or, in the case of a repair or change without MPV's consent or the consent of its recognised repairer, there will be no entitlement to repairs or replacement. The parts that have to be replaced must be made available free of charge to MPV. Noncompliance by the other party to one or more of its obligations will release MPV of all its guarantee obligations. In the case of assembly of the other party's own products by Maretti, MPV will release itself from all guarantee stipulations. Moreover, our general delivery terms and conditions are applicable. These can be obtained from Maretti or can be downloaded from www.maretti.com

The installation must be done by a competent installer. Maretti recommends that your (outside) lighting and fixtures are inspected and maintained annually.

D: Für Garantiebedingungen bitte lesen Sie unsere Webseite www.maretti.com
E: Consulte nuestro sitio web para los condiciones de garantía www.maretti.com
FR: Consultez notre site web pour les conditions de garantie www.maretti.com
NL: Voor garantievoorwaarden zie onze website www.maretti.com

13.1569.COLOUR
13.1565.COLOUR

OAK SUSPENDED 16 LIGHTS
OAK SUSPENDED 24 LIGHTS



13.1569.04



13.1569.05



13.1569.44

COLOUR FIXTURE

BLACK WHITE WOOD



Available in other colours at additional cost, price on request.		COLOUR FIXTURE		
		BLACK	WHITE	WOOD
COLOUR SHADES	Outside: Black Inside: Gold	✓	•	•
	Outside: White Inside: Silver	•	✓	✓

GENERAL INFORMATION			
230V	VOLTAGE	IP20	IP RATING
	GU10 BULBS INCL.		CE MARK
	E14 BULBS INCL.		
	INDOOR		

INFORMATION PER LIGHTSOURCE			
LIGHT-SOURCE	MAX. WATTAGE FOR OAK 16L	MAX. WATTAGE FOR OAK 24L	
GU10	MAX. 4x10W	MAX. 6x10W	DIMMABLE
E14	MAX. 12x10W	MAX. 18x10W	DIMMABLE

13.1569.COLOUR

13.1565.COLOUR

OAK SUSPENDED 16 LIGHTS

OAK SUSPENDED 24 LIGHTS

EXTRA INFO.

LICHTBRON: APART VERKRIJGBAAR / LIGHT BULB: SEPARATE ORDER

ART. NR.	NAAM / NAME	SOCKET	VOL-TAGE	WATTAGE	KELVIN / CTA	LUMEN	CRI	BUNDELHOEK / BEAM ANGLE
21.8550.92	DOMINGO LED (DIM.)	GU10	230V	5,5W	2700K	350 lm	Ra90	38°
21.8555.92	DOMINGO LED (CTA DIM.)	GU10	230V	5,5W	CTA 2200-2800K	350 lm	Ra90	38°
21.9147.45	GIRATO BULB P45 (DIM.) AMBER KOGEL	E14	230V	3,5W	2000K	130 lm	Ra90	38°

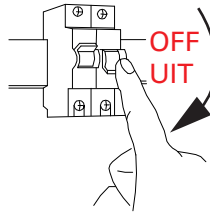

Schakel altijd eerst de stroom uit voordat u installatie-, onderhoud of reparatiewerkzaamheden uitvoert.

Always switch off the mains voltage before carrying out installation, maintenance and repair work.

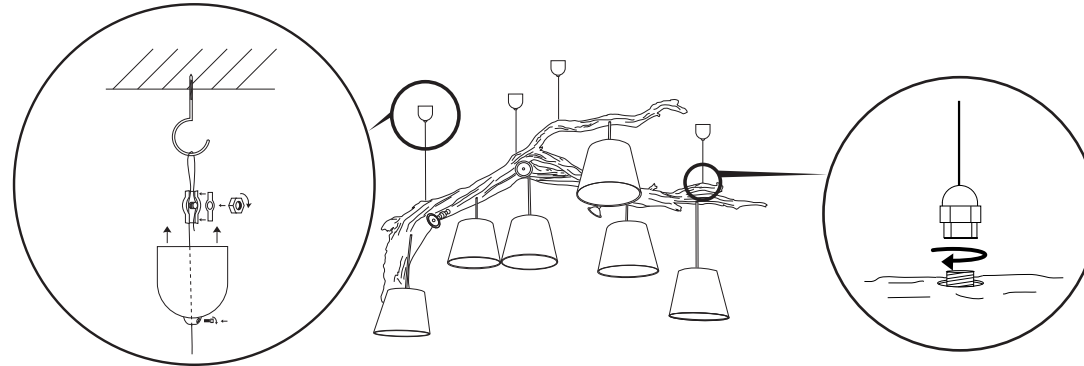
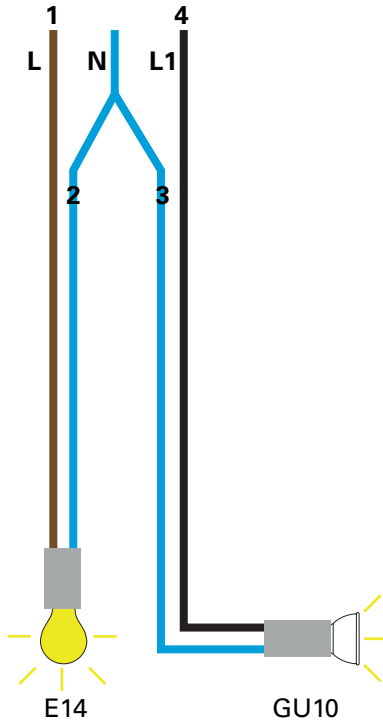

Handmade: this product is unique and may vary slightly in size.

13.1569. Oak suspended 16L

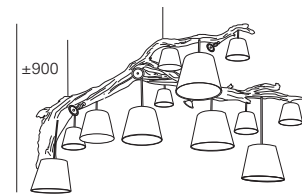

Sizes between 2000 and 2300mm is 16 lights

13.1565. Oak suspended 24L

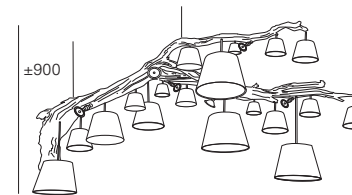

Sizes between 2300 and 2600mm is 24 lights

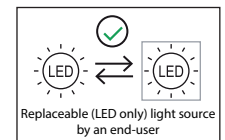

LET OP: Volg en bewaar deze gebruiksaanwijzing.

- Zorg ervoor dat de netspanning uitgeschakeld is voor installatie, reparatie of onderhoud. (Installatie, reparatie en onderhoud uitsluitend door gekwalificeerde personen).
- Voor reparatie of onderhoud uitsluitend originele delen gebruiken. Probeer het product niet zelf te demonteren en te repareren, onjuiste reparaties kunnen het product beschadigen en elektrische schokken veroorzaken wat tot ernstig letsel kan leiden.
- Gebruik het armatuur alleen binnenshuis.
- Het armatuur niet in vochtige of natte ruimte gebruiken.
- Uitsluitend op het etiket aangegeven lichtbronnen gebruiken.

Natuurproduct:

Hout is een natuurproduct. De kleur- en structuurverschillen, alsook het buigen en barsten van het hout, behoren tot de natuurlijke kenmerken en kunnen geen aanleiding geven tot klachten. Maretti kan geen enkele hieraan gerelateerde klacht aanvaarden voor reeds geplaatste materialen.

De fabrikant aanvaardt geen enkele aansprakelijkheid voor letsel of schade als gevolg van een verkeerde toepassing van het armatuur. De fabrikant aanvaardt geen garantie in geval van het niet behandelen van de lampen volgens de richtlijnen van de fabrikant. Als er schade aan elektrische onderdelen te vinden zijn, vraag dan een electricien om het te vervangen.

Onderhoud is behoud:

- Een goede instandhouding van het armatuur is sterk afhankelijk van omgevings- en onderhoudsfactoren. Hierop kunnen wij geen invloed uitoefenen.
- Schakel voor de zekerheid de elektriciteit uit!
- Gebruik geen bijtende, chemische of schurende schoonmaakmiddelen.

NOTE: Follow and keep this instructions manual.

- Make sure that the mains voltage is switched off for installation, repair or maintenance. (Installation, repair and maintenance only by qualified persons).
- Use only original parts for repairs or maintenance. Never attempt to disassemble, repair or alter the product in any way, improper repairs could damage the product causing electrical shocks which may cause serious injury.
- Use the fixture only indoors.
- Don't use the fixture in humid or wet areas.
- Use only suitable light sources indicated on the label.

Natural product:

Wood is a natural product. Differences in colour and structure, as well as bending and cracking of the wood are some of its natural characteristics. Maretti cannot accept any complaints related to damage caused by these and other natural characteristics that may occur after the fixtures have been installed.

The manufacturer accepts no liability for any injuries or damages resulting from the incorrect use or installation of the fixture. Any operation performed on the fixture that is not in accordance with instructions will void manufacturer's warranty. If you find any damage to the electrical parts, please ask a qualified electrician to replace it.

Maintenance is preservation:

- A good preservation of the fixture is highly dependent on environmental factors and maintenance. We cannot exercise any influence on this.
- Make sure that the mains voltage is switched off before you begin.
- Do not use strong, chemicals or abrasive cleaners.

"No rights can be derived from the information provided on this Instruction Manual. Information on the Instruction Manual has been compiled with the utmost care and is updated on a continuous basis. Nevertheless Maretti cannot guarantee that all information is free of errors, complete or fully up to date."